

CTN MUC

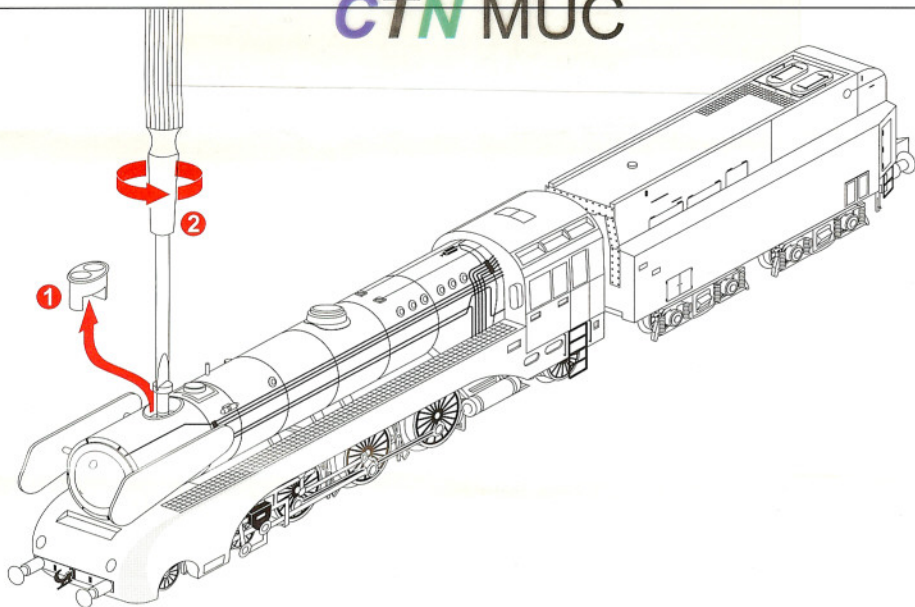

Kessel mit Umlauf anheben und vom Fahrrahmen abnehmen.
Lift boiler with circumference at the rear end and remove it from the chassis frame.
Solevez le générateur de vapeur avec pourtour à l'arrière et enlevez-le du cadre de chassis.

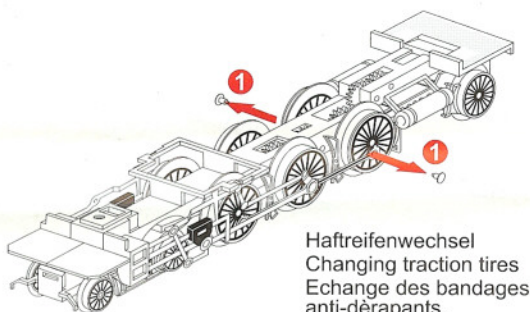
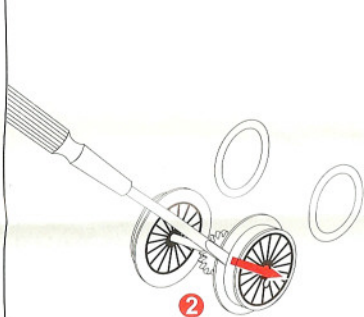
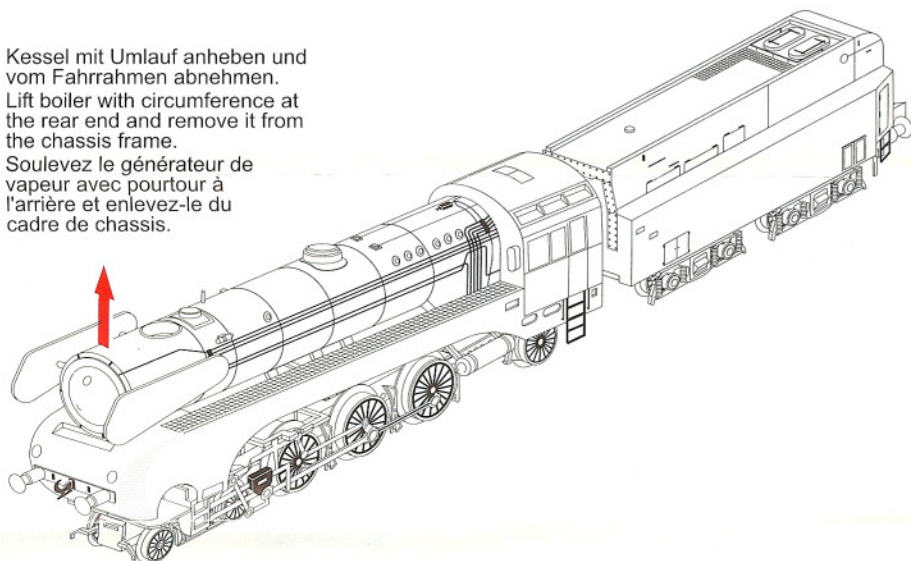

Haftreifenwechsel
Changing traction tires
Echange des bandages anti-dérapants.

Die Montage erfolgt jeweils in umgekehrter Reihenfolge!
For reassembly reverse the above order!
Rassemblez à l'inverse!

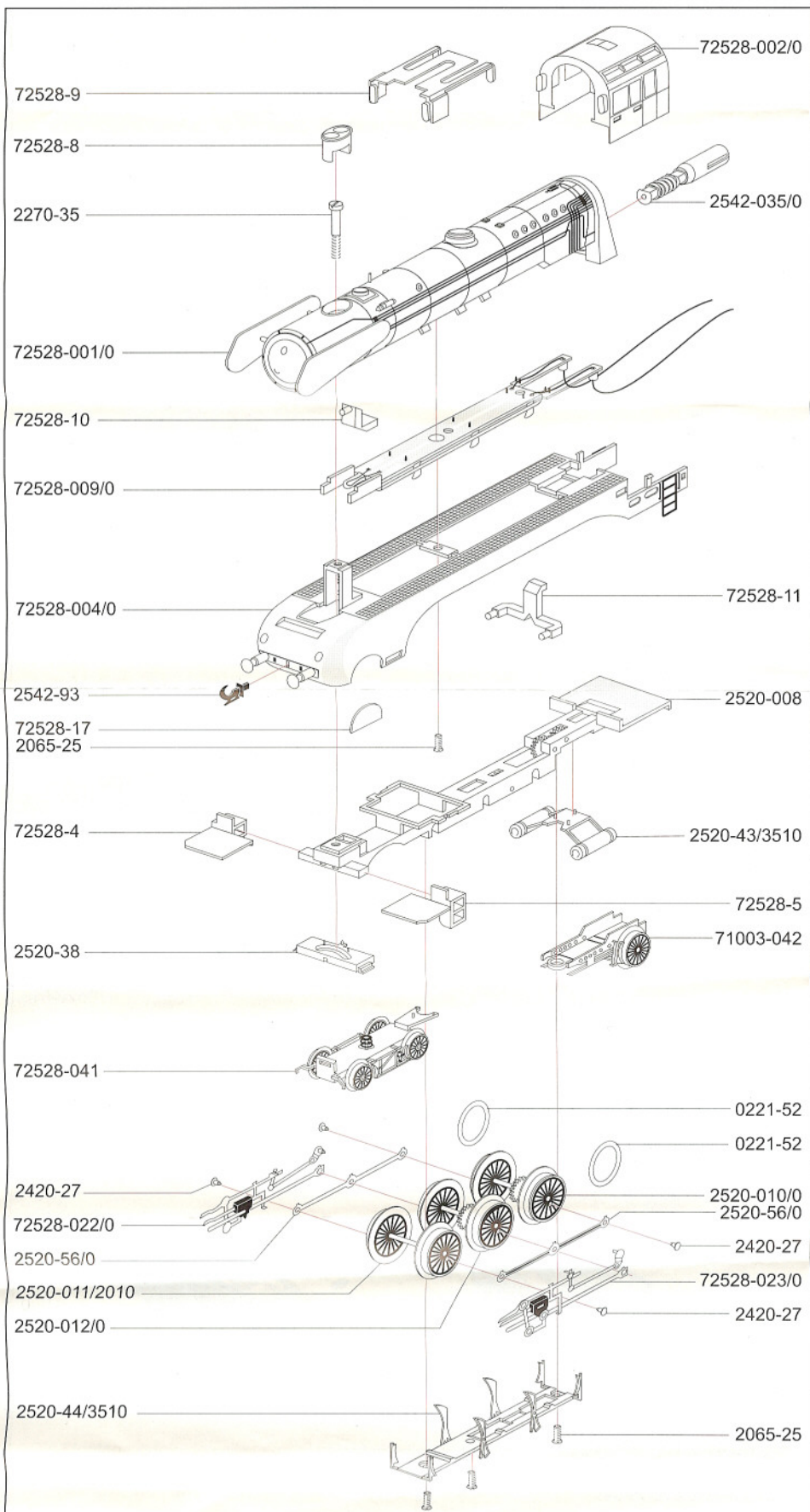

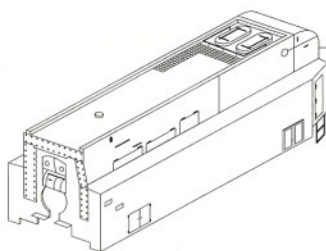

72528-019/0



2520-60

2520-91

2520-49

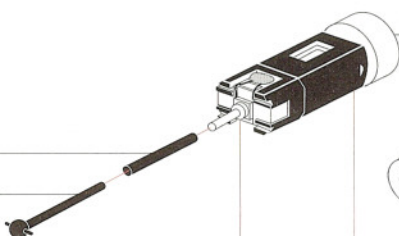

72528-020/0

4601-25

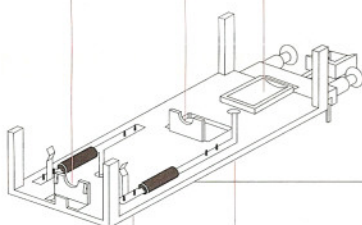

72528-018

72528-034

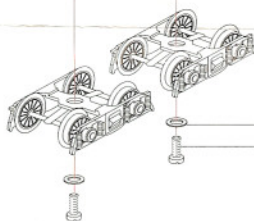

72528-016

3350-50

0220-32.5



72528-70

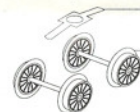

2520-015/0

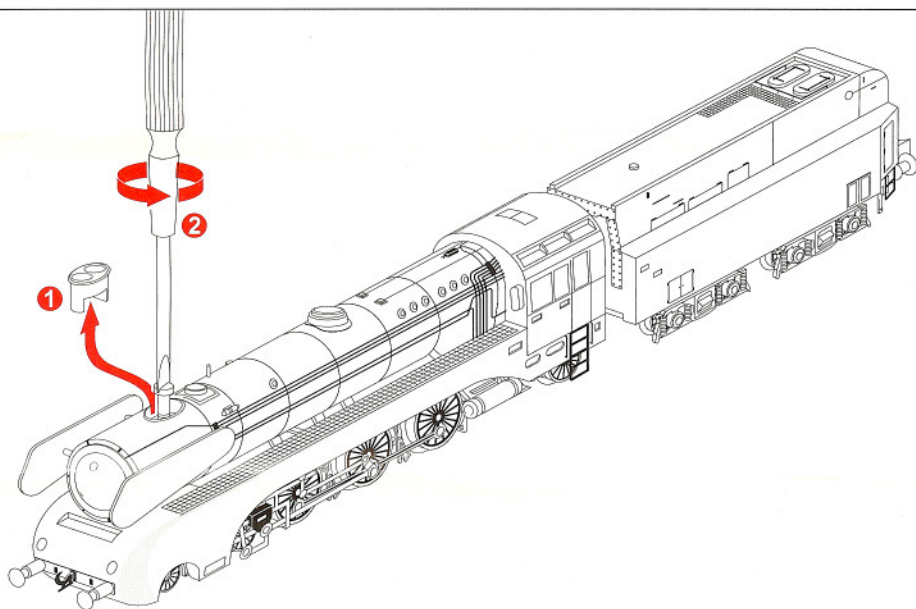

Kessel mit Umlauf anheben und vom Fahrrahmen abnehmen.

Lift boiler with circumference at the rear end and remove it from the chassis frame.

Soulevez le générateur de vapeur avec pourtour à l'arrière et enlevez-le du cadre de chassis.

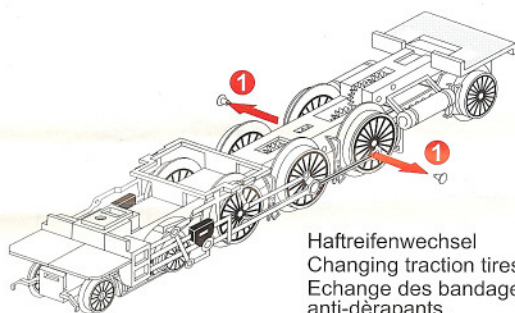
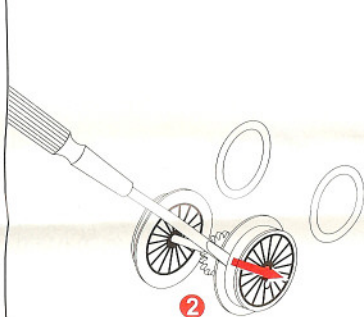
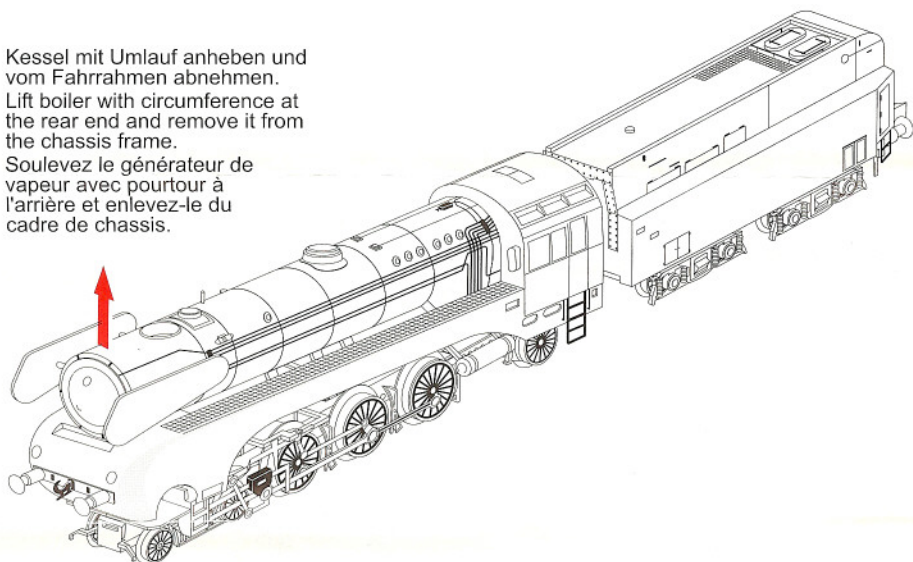

Haftreifenwechsel
Changing traction tires
Echange des bandages
anti-dérapants.

Die Montage erfolgt jeweils in umgekehrter Reihenfolge!

For reassembly reverse the above order!

Rassemblez à l'inverse!